

NOTICE: WHEN GOVERNMENT DRAWINGS, SPECIFICATIONS, OR OTHER DATA ARE USED FOR ANY PURPOSE OTHER THAN IN CONNECTION WITH A DEFINITELY RELATED GOVERNMENT PROCUREMENT OPERATION, THE UNITED STATES GOVERNMENT THEREBY INCURS NO RESPONSIBILITY FOR ANY OBLIGATION WHATSOEVER; AND THE FACT THAT THE GOVERNMENT MAY HAVE FORMULATED, FURNISHED, OR IN ANY WAY SUPPLIED THE SAID DRAWINGS, SPECIFICATIONS, OR OTHER DATA IS NOT TO BE REGARDED BY IMPLICATION OR OTHERWISE AS IN ANY MANNER LICENSING THE HOLDER OR ANY OTHER PERSON OR CORPORATION, OR CONVEYING ANY RIGHTS OR PERMISSION TO MANUFACTURE, USE, OR SELL ANY PATENTED INVENTION THAT MAY IN ANY WAY BE RELATED THEREBY.

THIS DOCUMENT HAS BEEN PURCHASED BY THE GOVERNMENT AND MAY BE REPRODUCED AND USED IN CONNECTION WITH ANY GOVERNMENT PROCUREMENT OR MAINTENANCE OPERATION.

* FOR INFORMATION ONLY. CONTRACTOR MAY AT HIS OPTION DEVIATE FROM THESE PROCESS DETAILS.

| REVISIONS | | | |
|-----------|---|-----------|--------------------------|
| SYM | DESCRIPTION | DATE | APPROVAL |
| A | (1) ADDED NEW APPL SM-B-248953 | 27 JAN 60 | 42428-PC REV'D PME |
| B | (1) .318/.320 WAS .316/.318 (2) .248/.249 WAS .2492±0002 | 22 FEB 61 | 42428-PC REV'D PME |

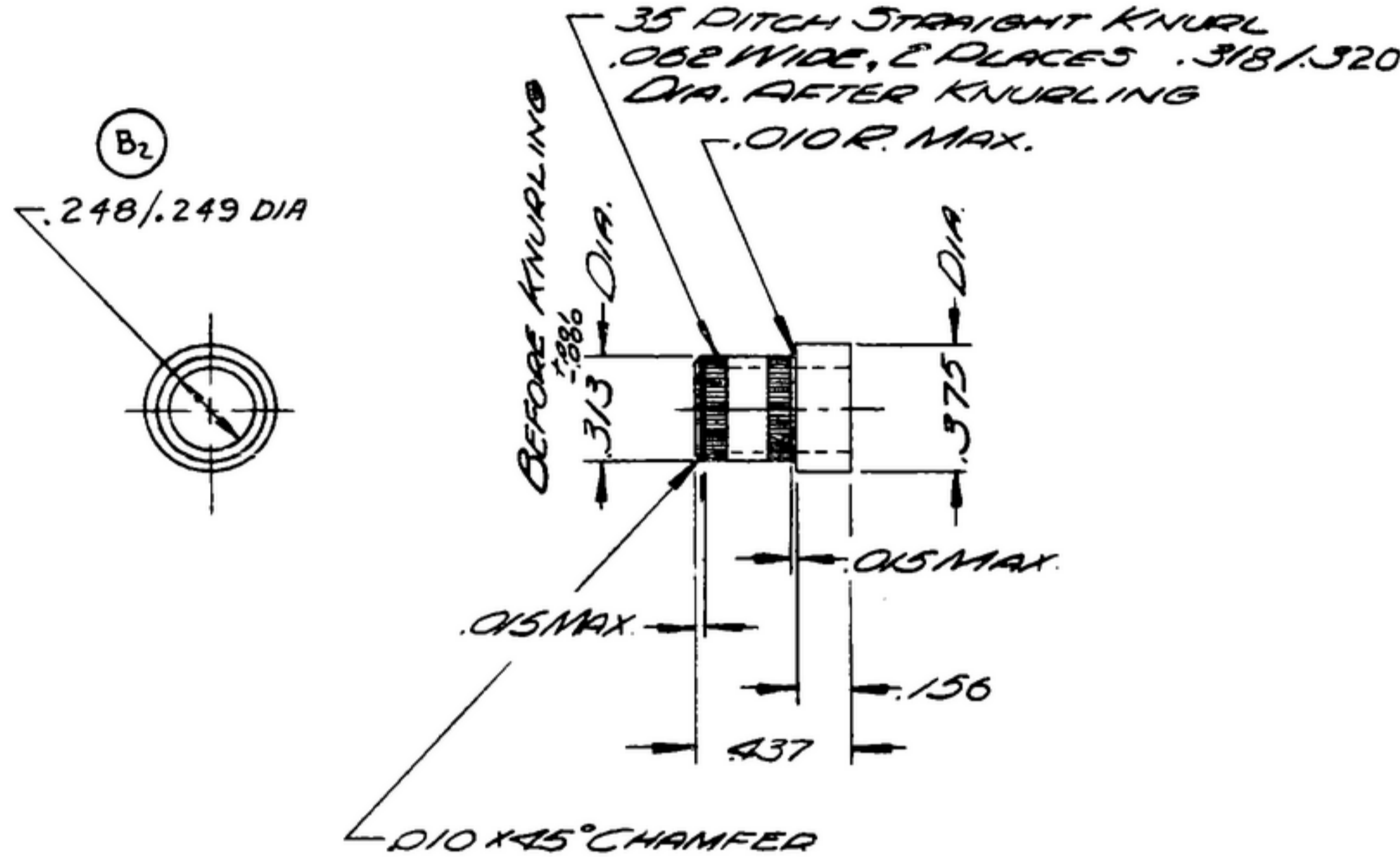

CRES, COMP 3035, COND B, SURFACE COND. d, PER SPEC MIL-S-7720.

| GOLLINS PART NO. | ITEM | REQD | PART NO. | DESCRIPTION | DATE | DATE SPEC |
|--------------------------------------|------|------|----------|-------------|------|-----------|
| LIST OF MATERIAL | | | | | | |
| GOLLINS PART NO. <i>558 0565 002</i> | | | | | | |

| GOLLINS NO. | QTY | NEXT ASSY | USED ON |
|---------------------|----------|--------------------|--------------------|
| <i>558 0565 002</i> | <i>1</i> | <i>SM-B-248953</i> | <i>SM-C-283271</i> |

DRAWN
RDE

CHECKED
BG

APPROVED

UNLESS OTHERWISE SPECIFIED:
 DECIMAL DIMENSIONS INCLUDING HOLE SIZES MAY VARY ±.008
 FRACTIONAL DIMENSIONS INCLUDING HOLE SIZES MAY VARY ±1/64
 MACHINED ANGLES MAY VARY ±.1°
 SHEARED ANGLES MAY VARY ±.25°
 BROKEN ANGLES MAY VARY ±1°
 ECCENTRICITY BETWEEN ANY DIAMETERS ON THE SAME CENTERLINE SHALL NOT EXCEED .010 TOTAL INDICATOR READING.
 ALL DIMENSIONS ARE FINISH DIMENSIONS INCLUDING APPLIED FINISH AND ARE GIVEN IN INCHES.

GOLLINS RADIO CO.
 6800 RAYBURN TOWNSHIP
 14214 - PH -
 51 - 93

SIGNAL CORPS

REVIEWED *PME*

APPROVED *HLV*
PME

DATE *20 FEB 58* SCALE *2/1*

HUB-CAM

DEPARTMENT OF THE ARMY
 SIGNAL CORPS ENGINEERING
 LABORATORIES

FORT MONMOUTH NEW JERSEY

SM-B-283271